

FREESTANDING

CURVE

10 & 12 KW SINGLE SIDED



INFINITI 12 KW CURVE

Our 10 & 12 Kw Curve units are designed with gentle curves on either side to give this unit a smooth oval look.

The larger convection chamber and ventilated top plate enhances air circulation to improve the efficiency of the unit, as well as decreasing the temperature of the steel side walls for a safer touch by hands.

The unit functions equally well whether positioned on a flat wall or orientated across a corner.

HEATING CAPACITY

10 Kw ▶ 400 m³ | 12 Kw ▶ 480 m³



VIEW OF NEW PULL OUT TABLE WHEN OPEN

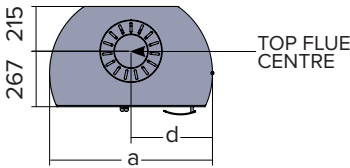
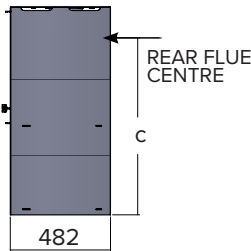

	a	b	c	d
10 Kw	700	903	753	350
12 Kw	783	1000	850	392

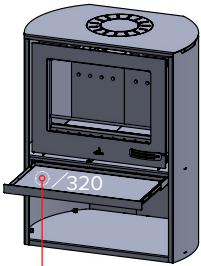

NEW PULL OUT TABLE